

Frame anchor with hex head HRD-HR2



Base materials

- Concrete (aerated)
- Concrete (cracked)
- Concrete (hollow deck)
- Concrete (uncracked)
- Masonry (grout-filled CMU)
- Masonry (hollow)
- Masonry (hollow CMU)
- Masonry (solid)

Applications

- Fastening metal substructures for ventilated facades
- Typical applications for metal fabricators such as fastening handrails, window bars, railings, balustrades, etc.

Advantages

- Flexible embedment depth (approved at 50 mm and 70 mm embedment depth) - the ideal anchor for a huge range of applications in virtually all base materials
- Suitable for fastening thicknesses up to 150 mm (anchor lengths from 60 mm to 200 mm)
- Available in 4 different materials for optimum suitability in all corrosive environments

Technical data

Material composition	Steel, A2 (SS 304) or duplex equivalent, Polyamide
Head configuration	Hex head
Anchor size	10 mm
Suitable for cracked concrete with redundant fastenings	Yes

Approvals

ETA | ETA-07/0219 for HRD (ETAG 020-01, Option -)

Approvals and test reports may apply to selected products only. Please refer to the documents for details.

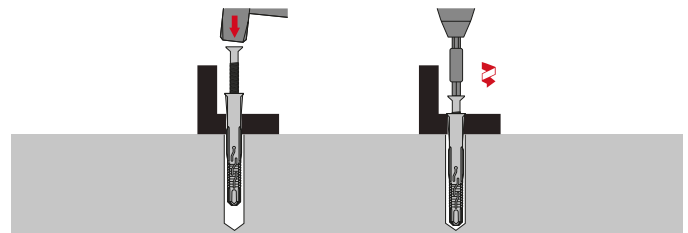

These are abbreviated instructions which may vary by application. Always review/follow the instructions accompanying the product or refer to www.hilti.com/techlib.

Ordering designation	Drill bit diameter	Anchor length	Embedment depth 1	Embedment depth 2	Fastening thickness at embed.2	Screw head diameter	Sales pack quantity	Item number
HRD-HR2 10x60	10 mm	60 mm	50 mm			18 mm	50 pc	423897
HRD-HR2 10x120	10 mm	120 mm	50 mm	70 mm	50 mm	18 mm	50 pc	423900

Please visit our website for the latest item numbers and related products.